

INSTALLATION INSTRUCTIONS

* Trim kit items (2-11) & body kit items (1, 12, 13 & 14) are supplied in separate boxes.

* Trim kit items (3), (5), (7) & (10) are available in different colour finishes and styles.

Installation

- 1) Ensure that universal hob mixer body (1) 99687 was installed at the required position and orientation. The handle operates symmetric to the indication mark on the cartridge, see **Fig. 3**. To change the orientation of the handle operation, loosen the screws (14), reposition the mixer body as required and re-tighten the screws (14). **DONOT OVERTIGHTEN**
- 2) Ensure O-ring (2) is fitted into groove under the flange (3), screw flange (3) onto the thread of body (1) and hand tighten until 'O'-ring firmly contacts deck. Clean all contact surfaces of swivel cap (5), 'O'-ring and thrust washer(4), ensure they are clean and free from any debris. Lubricate the thrust washer (4), underside of cap (5) and 'O'-ring then fit the thrust washer(4) around the nut inside mixer body (1). Ensure that the cartridge stem is in closed position, fit the swivel cap (5) along with 'O'-ring into the mixer (1) and ensure the swivel cap cut-out is positioned as shown in **Fig.2**. Fit the insert (6) over the cartridge stem and push it down. Fit handle (7) taking care that it is pushed fully onto cartridge stem & bottomed on the plastic insert (6) then tighten screw (8) using the 2.5mm allen key (11). Fit handle plug (10) together with 'O'-Ring (9) into handle (7) taking care not to damage decorative finish.

Replacing Cartridge

- 1) Turn off hot and cold water supplies.
- 2) Carefully remove handle plug (10). Using 2.5mm allen key (11), loosen screw (8) and remove handle (7). Remove plastic insert (6) then extract swivel cap (5) and thrust washer (4) from the mixer body (1), taking care not to damage the decorative finish. **Hint:** The small end of the allen key (11) can be inserted into the slot in the swivel cap (5) and used to lever the cap vertically to remove.
- 3) Ensure inside face of mixer body (1) is clean. Check that seal is in position in base of new cartridge (13). Fit new cartridge (13) into mixer body (1), taking care that two lugs on base of cartridge (13) fit into mating holes in mixer body(1).
- 4) Screw on nut (12). **Important:** Nut (12) should be tightened to a torque of 7.5 Nm.
- 5) Clean all contact surfaces of swivel cap (5), 'O'-ring and thrust washer (4), ensure they are clean and free from any debris. Lubricate the thrust washer(4), underside of cap (5) and 'O'-ring then fit the thrust washer (4) around the nut (12). Ensure that the cartridge stem is in closed position with the flats on the stem orientated square with the outlet. Fit the swivel cap (5) along with 'O'-ring into the mixer body (1) and ensure the swivel cap cut-out is positioned as shown in **Fig.2**. Fit the insert (6) over the cartridge (13) stem and push it down.
- 6) Fit handle (7) taking care that it is pushed fully onto cartridge stem, then tighten grub screw (10) using the 2.5mm allen key (11). Fit plug (10), taking care not to damage the decorative finish.
- 7) Turn on water supplies and check handle operation.

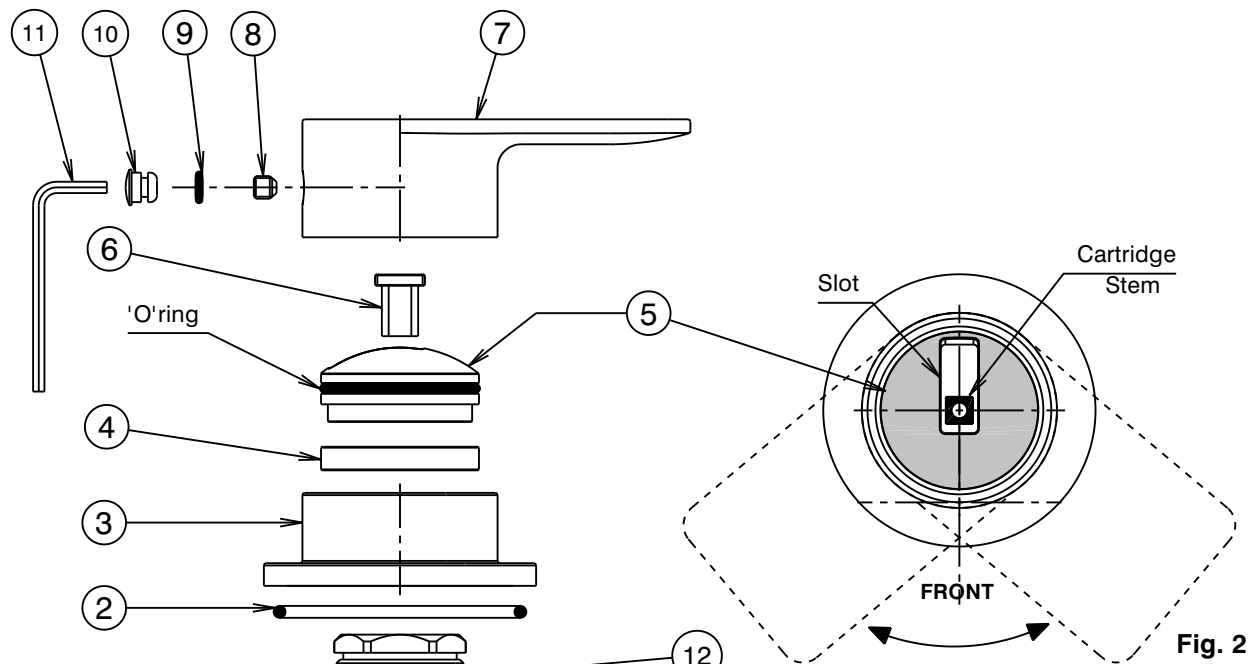

Fig. 2

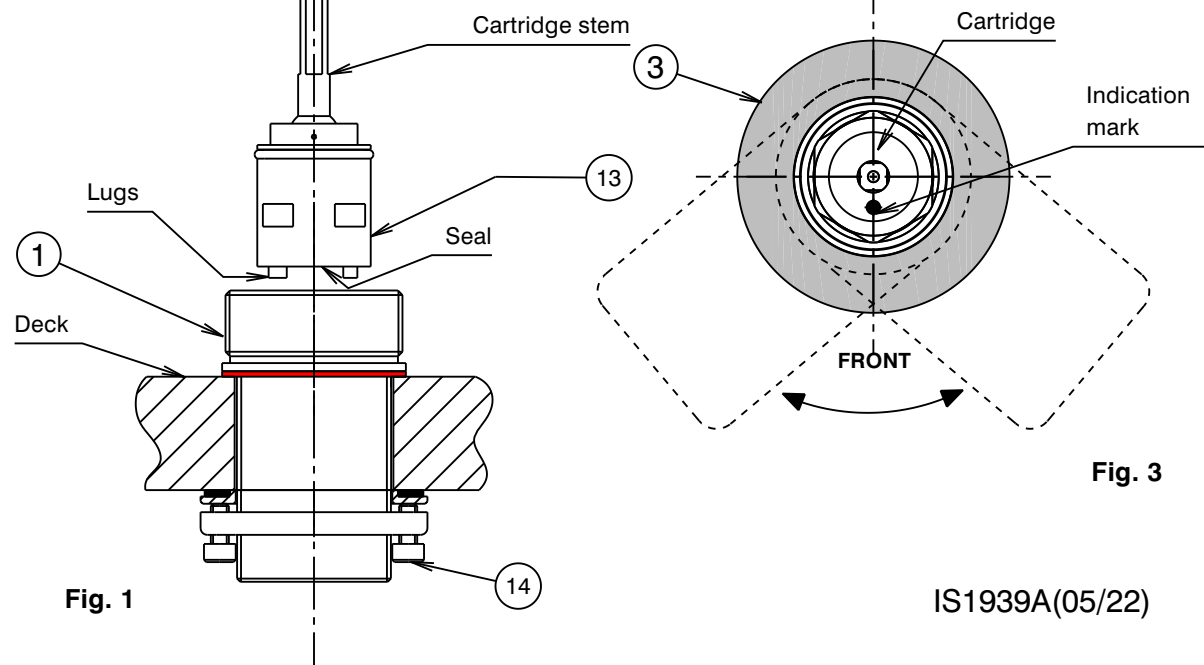

Fig. 3

Fig. 1