

# CAROMA URBANE II - UNIVERSAL SUPPORT ACCESSORIES

## INSTALLATION INSTRUCTIONS

### Important Information

Installation must be carried out by a licensed tradesperson (plumber/builder).  
Special care should be taken when drilling walls to avoid hidden pipes or electrical cables.  
Safety gear like a mask, ear muffs and glasses must be worn when using tools.

### POINTS TO CONSIDER

- \* **Cavity walls** - Please ensure the grab rail fixing points are secured to the wall's solid framing structure (i.e. studwork/wall supports) to ensure adequate mounting strength of the rail. To achieve this, you may be required to position the rail at an angle depending on the width between each wall stud and the length of rail you have selected.
- \* **Solid walls** - If you need to install rail onto a solid (i.e. brick or concrete) wall, appropriate drilling equipment and additional wall plugs will need to be purchased to ensure rail strength.  
**Please note:** It is required that these accessories are mounted to a secure and strong surface, and that the installer appropriate fixing materials for your wall and installation. To the fullest extent permitted by law, Caroma will not accept responsibility for personal injury or damage caused by incorrect installation or poor wall strength, or installation or part installation by any person other than a licensed tradesperson (plumber/builder).
- \* Support Rails are constructed to withstand a load of 1100Nm (113kg) vertical force.
- \* Over time, the mounting screws may become loose. Support accessories should be periodically checked that they are fastened securely to the wall and retighten or replace mounting screws when required.

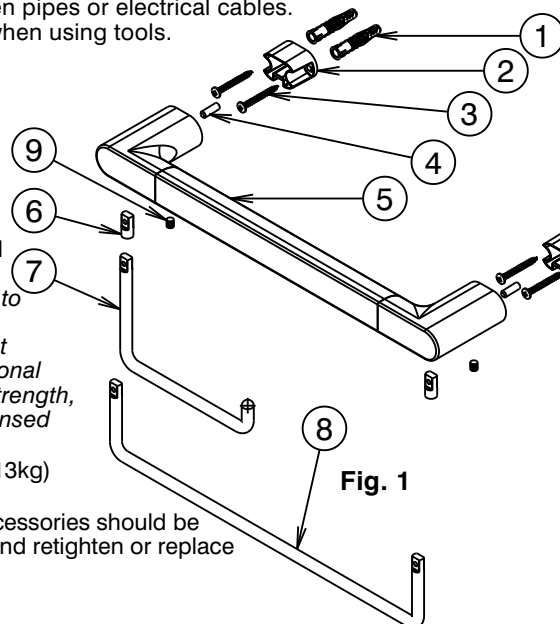

Fig. 1

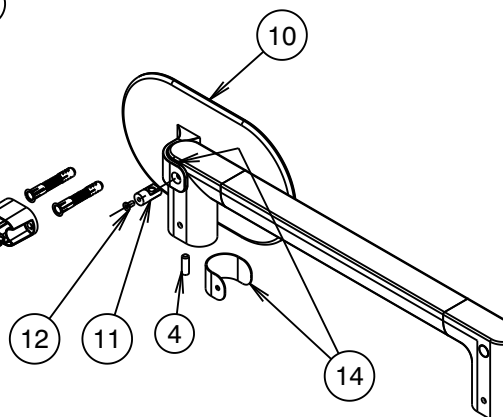

Fig. 2

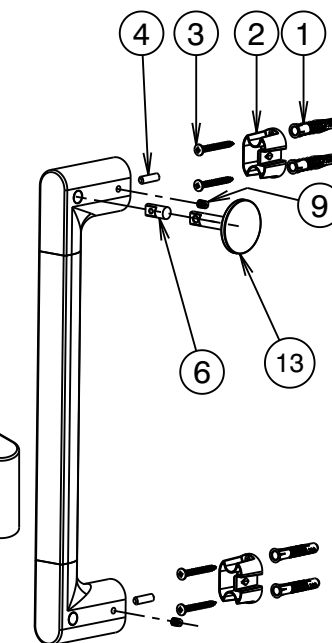

Fig. 3

### Installation

#### Installed Horizontally:

- 1) Position support rail in desired location against wall or fixing surface. To ensure top surface of support rail is horizontal, then using a pencil, mark mount block (2) position.
- 2) Remove mounting screws (9) to get mount blocks (2), using mount block (2) as a template to drill screw holes.
  - 2a) For fixing to a timber stud and non-structural walls, noggins or other suitable means of support must be used for the support Rail. Drill Ø6mm hole through tile surface and then a Ø2mm pilot hole 50mm deep into timber.
  - 2b) For fixing to brickwork, blockwork or concrete, drill Ø8mm hole 60mm deep. Remove templates. Insert wall plugs (1) into drilled holes. Ensure wall plugs (1) are flush with wall.
- 3) Using screws (3) to attach the mount blocks (2) securely to the wall.
- 4) If toilet roll (7) is required, loose screw (4) from back of post to remove insert (6), insert toilet roll holder (7) into support rail (5) from insert hole as shown in Fig. 1, then tighten screw (4) firmly.
- 5) For support rail 400mm, if towel rail is required, loosen screws (4) from back of post to remove inserts (6), insert towel rail (8) into support rail (5) from insert hole as shown in Fig. 1, then tighten screws (4) firmly.
- 6) If shelf (10) is required, loose screw (4) from back of post to remove insert (6) fit insert (10) with threads (11) into support rail from insert hole as shown in Fig. 2, fit shelf with gasket (14) onto support rail as shown in Fig. 2 to ensure the hole of shelf (10) and gasket (14) align with insert hole, then tighten screw (12).
- 7) Rail can now be installed onto mount blocks (2) and secured using mounting screws (9).

#### Installed Vertically:

- 1) Position support rail in desired location against wall or fixing surface. To ensure side surface of support rail is vertical, then using a pencil, mark mount blocks (2) position.
- 2) Remove grub screws (9) to get mount blocks (2), using mount block (2) as a template to drill screw holes.
  - 2a) For fixing to a timber stud and non-structural walls, noggins or other suitable means of support must be used for the support Rail. Drill Ø6mm hole through tile surface and then a Ø2mm pilot hole 50mm deep into timber.
  - 2b) For fixing to brickwork, blockwork or concrete, drill Ø8mm hole 60mm deep. Remove templates. Insert wall plugs (1) into drilled holes. Ensure plugs are flush with wall.
- 3) Using screws (3) to attach the mount blocks (2) securely to the wall.
- 4) If robe hook (13) is required, loose screw (4) from back of post to remove insert (6), insert robe hook (13) into support rail from insert hole as shown in Fig. 3, then tighten screw (4) firmly from back of post.
- 7) Rail can now be installed onto mount blocks (2) and secured using the grub screws (9).

