

PLUMBERS INSTALLATION INSTRUCTIONS

Important Information

- * Not suitable for gravity feed systems.
- * Body (1) is fitted with a flow regulator. This low flow rate may not be suitable for connection to some Instantaneous Gas Water Heaters, some Tempering Valves, some Solar Water Heaters & some Thermostatic Mixing Valves. Check with the manufacturers of these products. The flow regulator can be accessed as shown (Fig.1).
- * All pipework must be thoroughly flushed prior to installation, as foreign materials may block the flow regulating device and reduce the flow of water.

Installation

- 1) Wall lining hole should be cut or finished as per the dimensions shown (Fig.2).
- 2) The end of the threaded nipple must be $13 \pm 2\text{mm}$ from the wall/tile face, as shown (Fig.2). Cut to length using a nipple cutter fitted to a hand held power drill. Apply thread seal tape to the thread. **Important:** Care must be taken that thread seal tape cannot become dislodged and block the flow regulating device, causing a reduction in water flow.

- 3) Apply silicone sealant or equivalent to the tap body flange and screw the tap body onto the nipple (Fig.3).
- 4) Ensure that the tap is oriented with the spout pointing downwards.

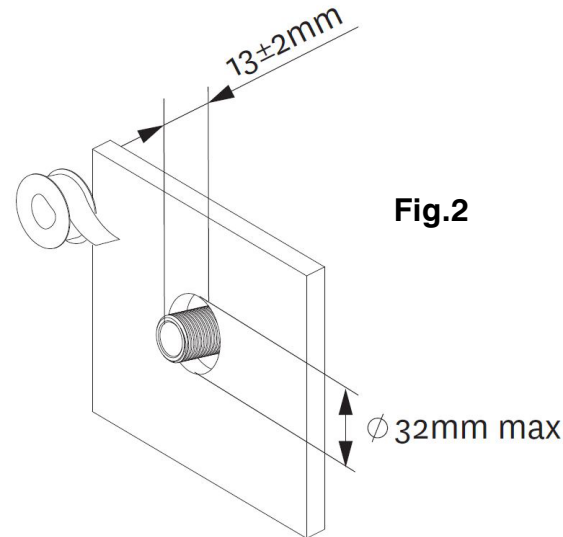

Fig.2

Inlet Connection:

1/2" BSP

IMPORTANT

Pressure & Temperature Requirements.

- Static inlet pressure range : 150 -1000 kPa
New Regulation : -500 kPa maximum static pressure at any outlet within a building. (Ref. AS/NZS 3500.1)
- Water temperature range: 5 - 50°C.

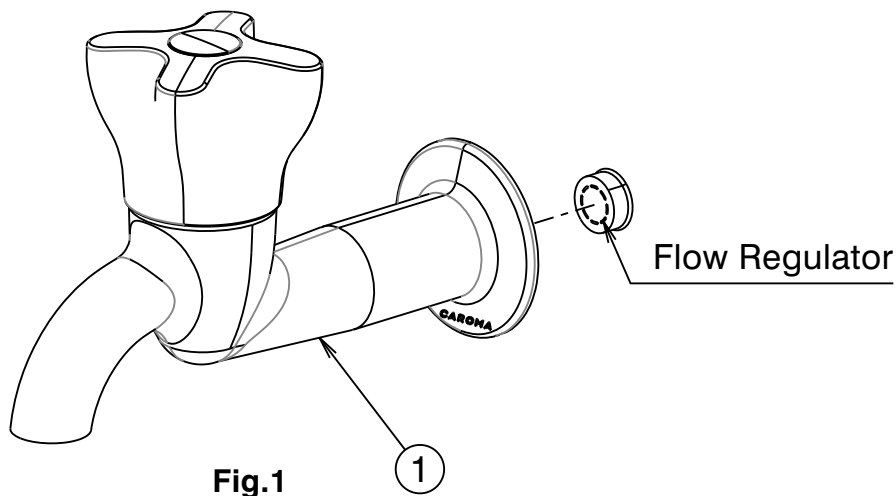

Fig.1

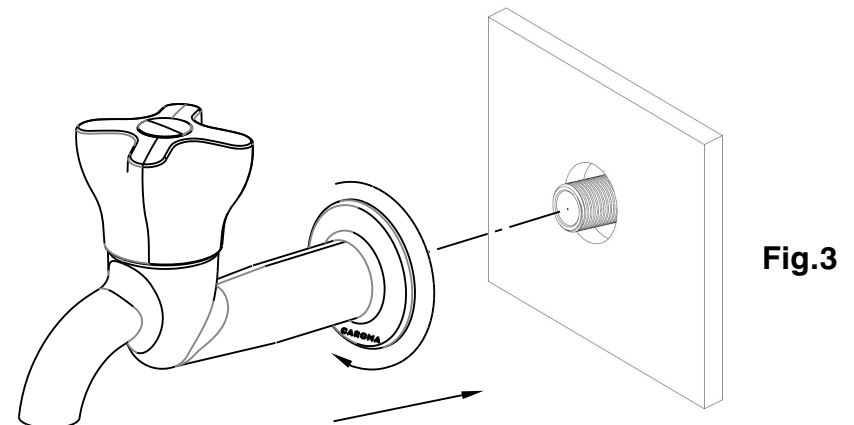

Fig.3