

# **Trident Care Connector Pan**

## **Vitreous China Pan for accessible applications**

### **Installations complying to the WC pan requirements to AS 1428.1-2009**

A contemporary designed 4.5 litre full flush **Trident Care Pan** with concealed trap pan is designed to provide a raised seat height of between 460-480mm for accessible applications . The pan features a concealed trap which facilitates easy cleaning. The versatility of the **Trident Care Pan** with concealed trap makes it ideal for use by both the ambulant people with disabilities and wheel-chair users including wheeled commode chairs.

**Important: Further reference must be made to AS 1428.1-2009 with current amendments to determine circulation space, grab rail and installation requirements. The dimensions in this sheet may change with amendments to the standards.**

**Pan:** **Trident Care Pan** with concealed trap, 4.5 litre full flush wash down type.

**Traps:** S-trap unvented only.

**Inlet:** 50mm back inlet.

**Cisterns:** The **Trident Care Pan** with concealed trap is recommended for use with the **Sovereign Cistern** (wall fix versions) and Caroma Care Push Button option.

**Position of the Pan:** For wheel chair access the installed pan must be  $800 \pm 10\text{mm}$  from the front of the pan to the finished wall and provide a seat height of 460 to 480mm. The projection requirements for people with ambulant disabilities is 610 to 660mm.

**Position of the Cistern:** The underside of the cistern must be 600mm minimum from the finished floor. The push button height must be no greater than 1100mm from the finished floor

**Seats:** Recommended Caroma seats – **Pedigree II Care**, **Caravelle Care** or **Colani** (sold separately).

**Installation:** Refer to *Important Information for Plumbers* section.

**Colours:** White only.

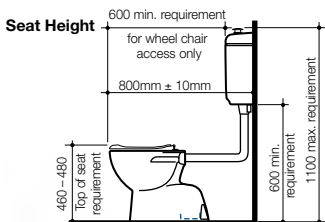

Caroma Care Push Button Option





# Trident Care Connector Pan (continued)

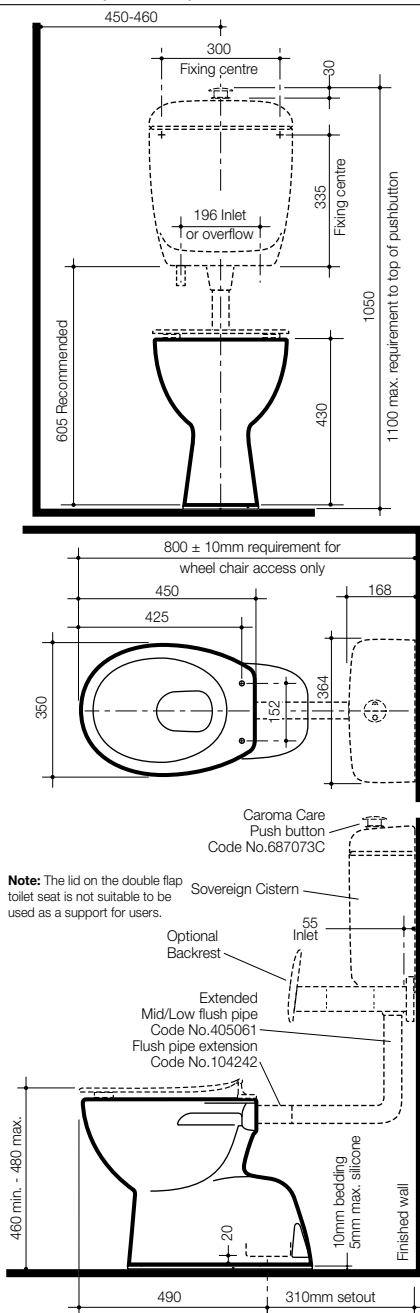

**Note:** The projection requirements detail on this illustration are for wheel chair access only. The projection requirements for people with ambulant disabilities is 610 to 660mm.

For height dimensions to underside of pan, make allowance for mortar bedding.